

NORTH DAKOTA STATE CAPITOL

1st Floor & Judicial Wing

- ★ Employee Entrance/Emergency Exit
- ||||| Stairs
- ⊠ Elevator (Gold/Tower)
- ⊠ Elevator
- ♂ ♀ Public Restrooms
- Light Blue Legislative Areas
- Teal Legislative Committee Rooms
- Grey Other/Storage/Agency
- * Public Entrance

1st Floor

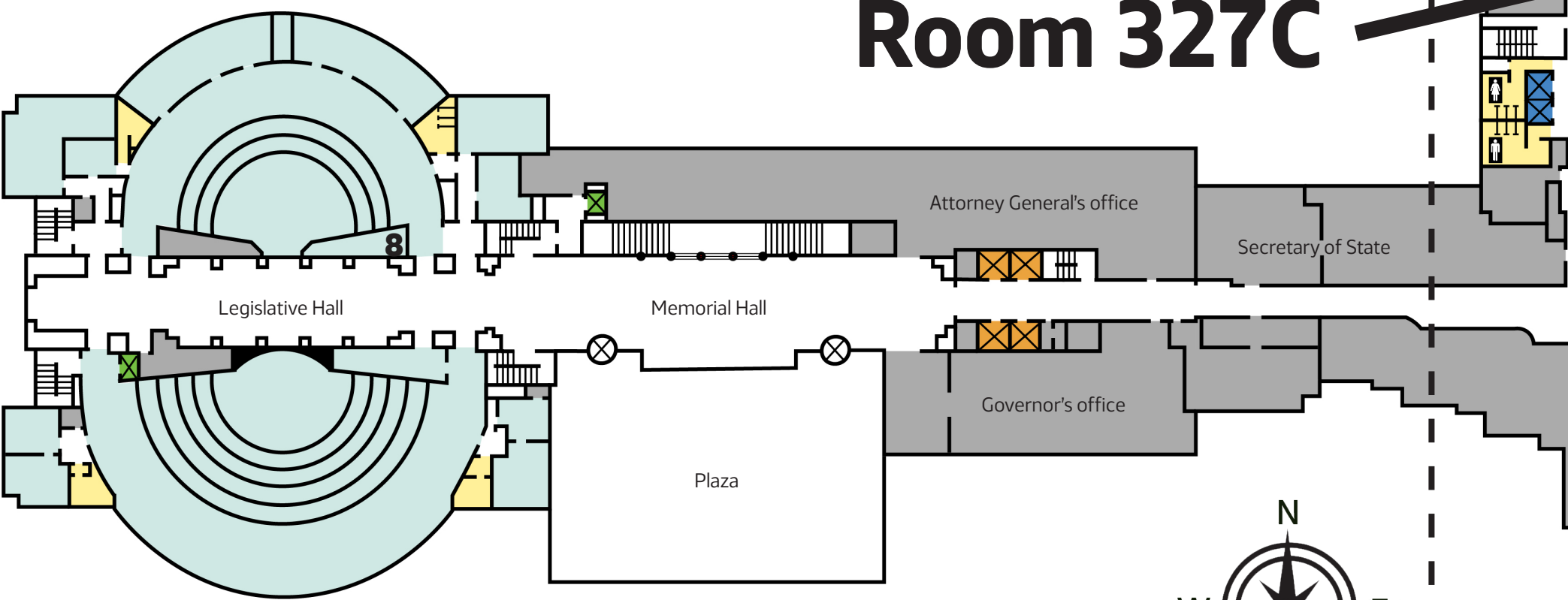

Room 327C

Judicial Wing

1st Floor

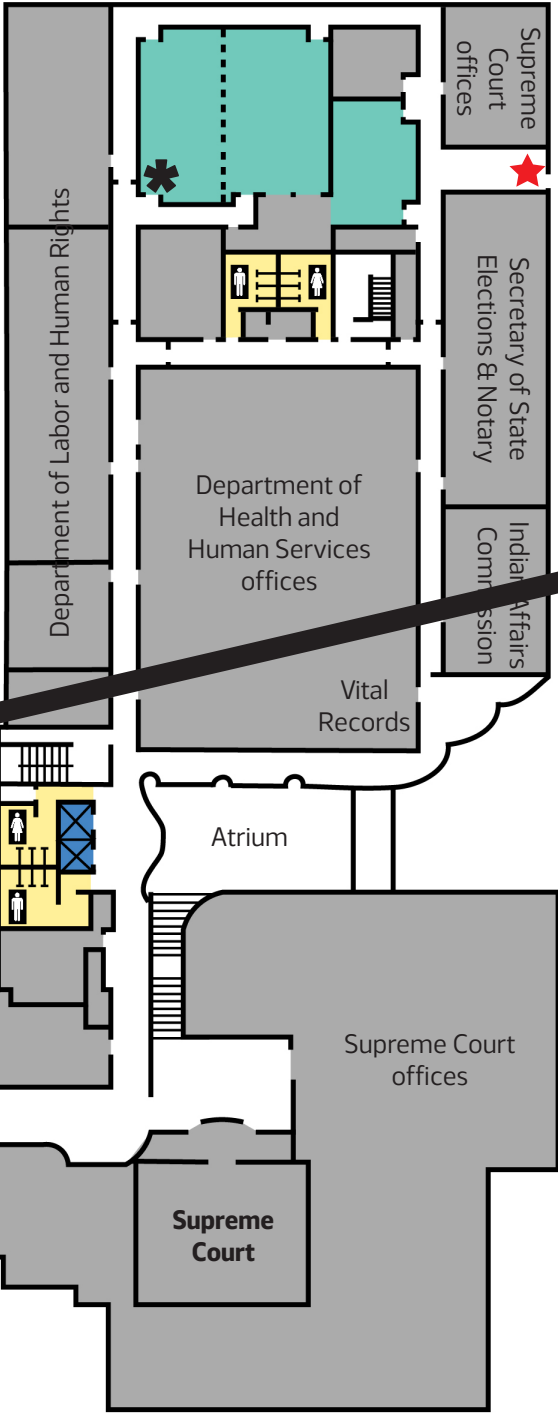

3rd Floor

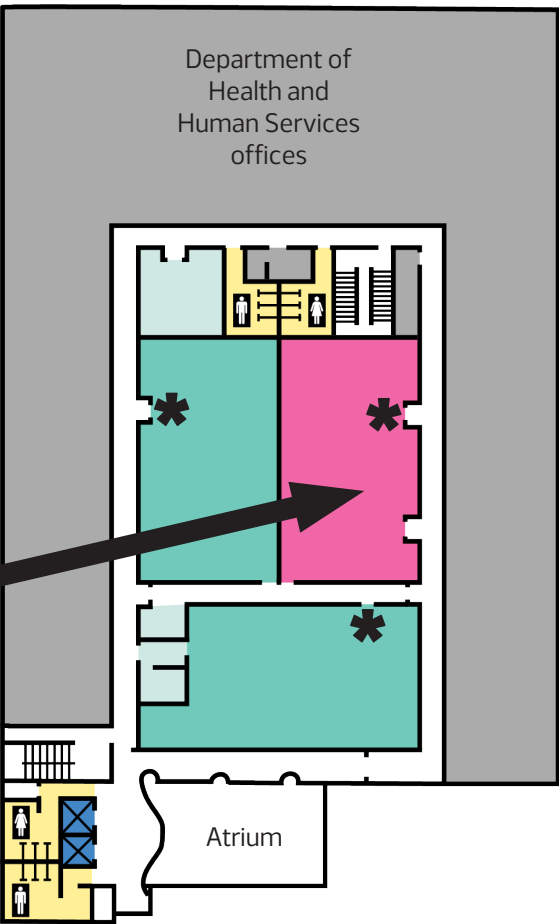

2nd Floor

