

Secondary Career
& Technical
Education

CIC Program
Coordination &
Support Services

Post-Secondary
CTE & General
Education

Adult Training
Workforce
Solutions



AGRICULTURE & PRECISION

YEAR 1
YEAR 2
YEAR 3

Launch new high school Agriculture Education program and align with Grand Farm events
Expansion of high school Agriculture Education program and align with Grand Farm events
Align high school to post-secondary dual credit



BUSINESS MANAGEMENT, MARKETING & ENTREPRENEURSHIP

YEAR 1
YEAR 2
YEAR 3

Define post-secondary program transition
Alignment with secondary business options for dual credit
Transition alignment between secondary, 2-year to 4-year programming

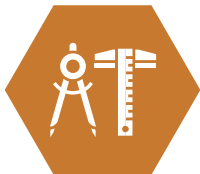

CONSTRUCTION TRADES

YEAR 1
YEAR 2
YEAR 3

Launch building systems program and construction courses
Solidify pre-apprenticeship training programs and partnerships
Expand building systems curriculums for specialized pathways



HEALTH & ALLIED SCIENCES

YEAR 1
YEAR 2
YEAR 3

Expansion of Nursing and EMS program
Secondary Medical Information and Pharmacy Tech
Biomedical sciences and emerging allied sciences



LIBERAL ARTS & GENERAL EDUCATION

YEAR 1
YEAR 2
YEAR 3

Launch Early-Entry options for high school transition
Launch high school integrated learning options
Increase Early-Entry and 4-year transitions



MANUFACTURING, ENGINEERING & ROBOTICS

YEAR 1
YEAR 2
YEAR 3

Welding and fabrication lab expansion
Launch of RAMT program
Robotic team and maker space lab school alignment



TRANSPORTATION & AUTONOMOUS SYSTEMS

YEAR 1
YEAR 2
YEAR 3

Launch UAS course offerings
Launch Diesel Technology course offerings
Launch Autonomous systems program



WORKFORCE & BUSINESS TRAINING

YEAR 1
YEAR 2
YEAR 3

Expansion of workforce training for skilled trades
Increase ApprenticeshipND courses and high school work-based learning options
Expand business partnerships supports for CIC programs



A public-private partnership to expand career exploration and advance workforce development in Cass County!

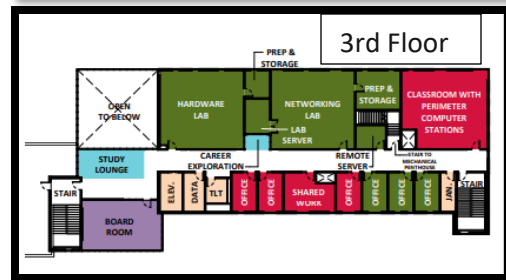
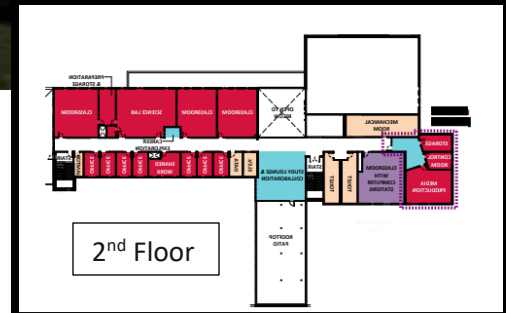
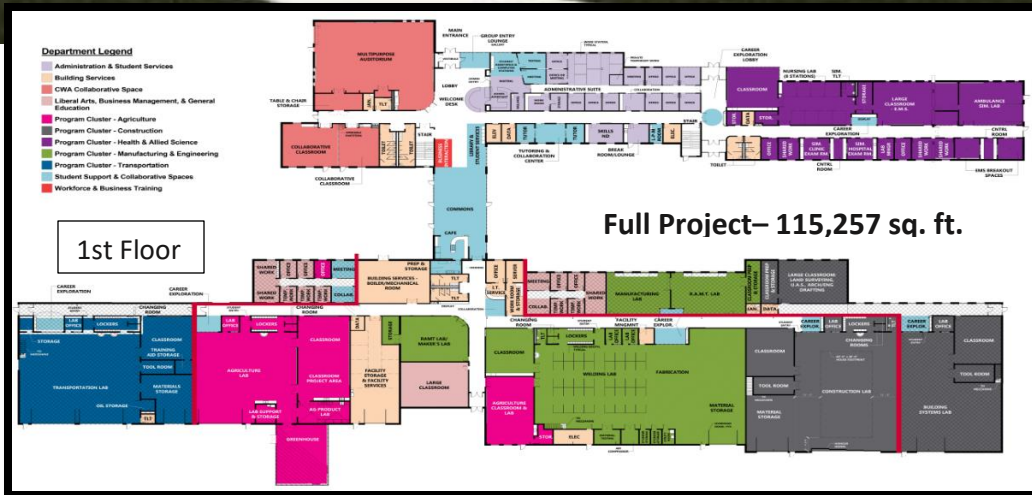

	Step 1	Step 2	Step 3
Completed Usable Space	57,000 sq. ft.	92,169 sq. ft.	115,257 sq. ft.
Funding Amounts and Sources	\$21.2 million: Private contributions	\$31.2 million: private + awarded \$10 million COVID grant	\$39.4 million: private + awarded \$10 million COVID grant + inflation impact funding
Construction and Program Milestones	Exterior shell and limited programs	Expanded interior build out and additional programs	Full build out and all planned programs
Approval Status	Signed contract for nearly \$18 million	On hold pending 2023 legislative action	On hold pending 2023 legislative action

