



**GREAT PLAINS
FOOD BANK**

Melissa Sobolik
CEO



Service Map

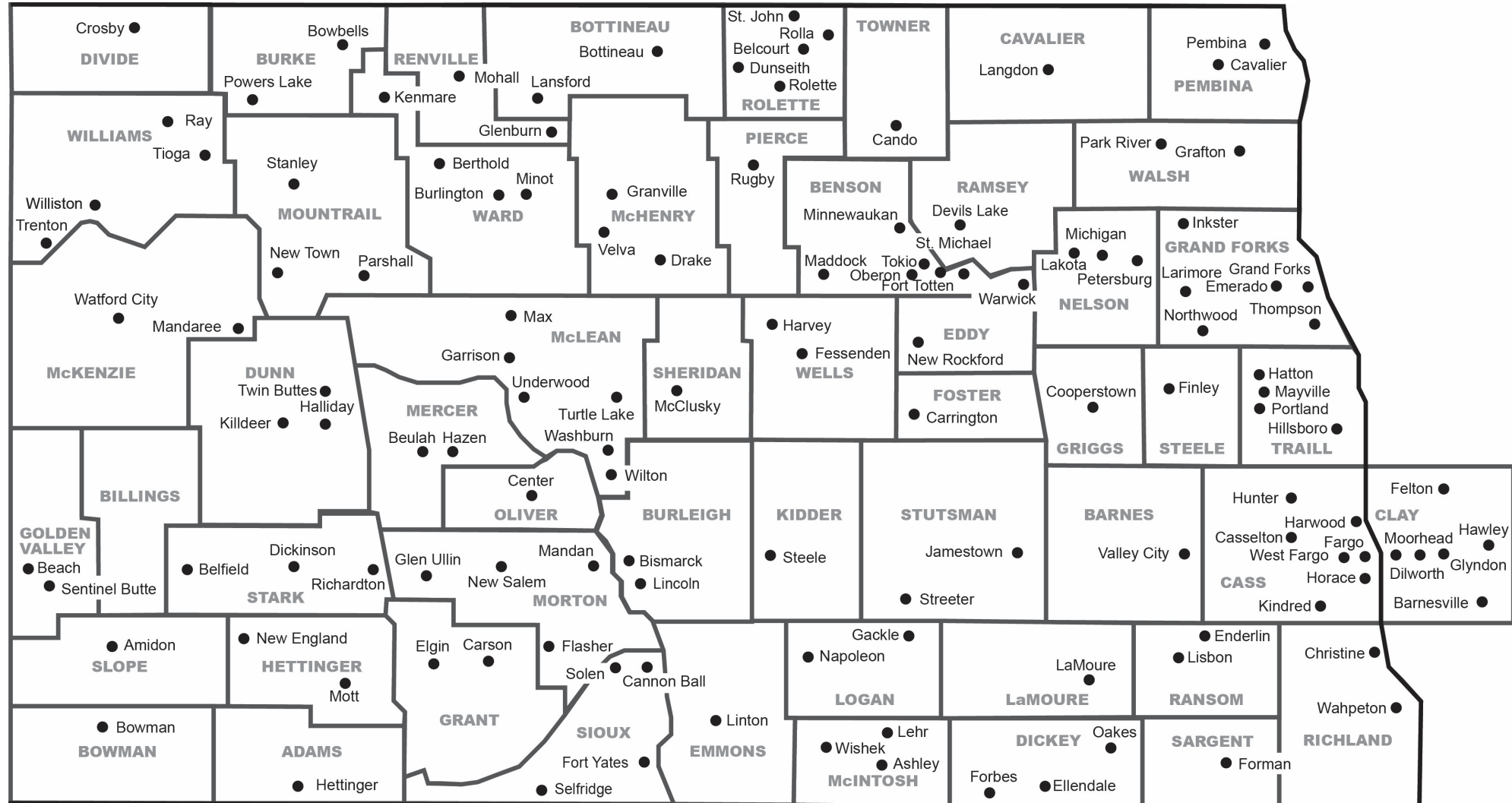

Individuals Served

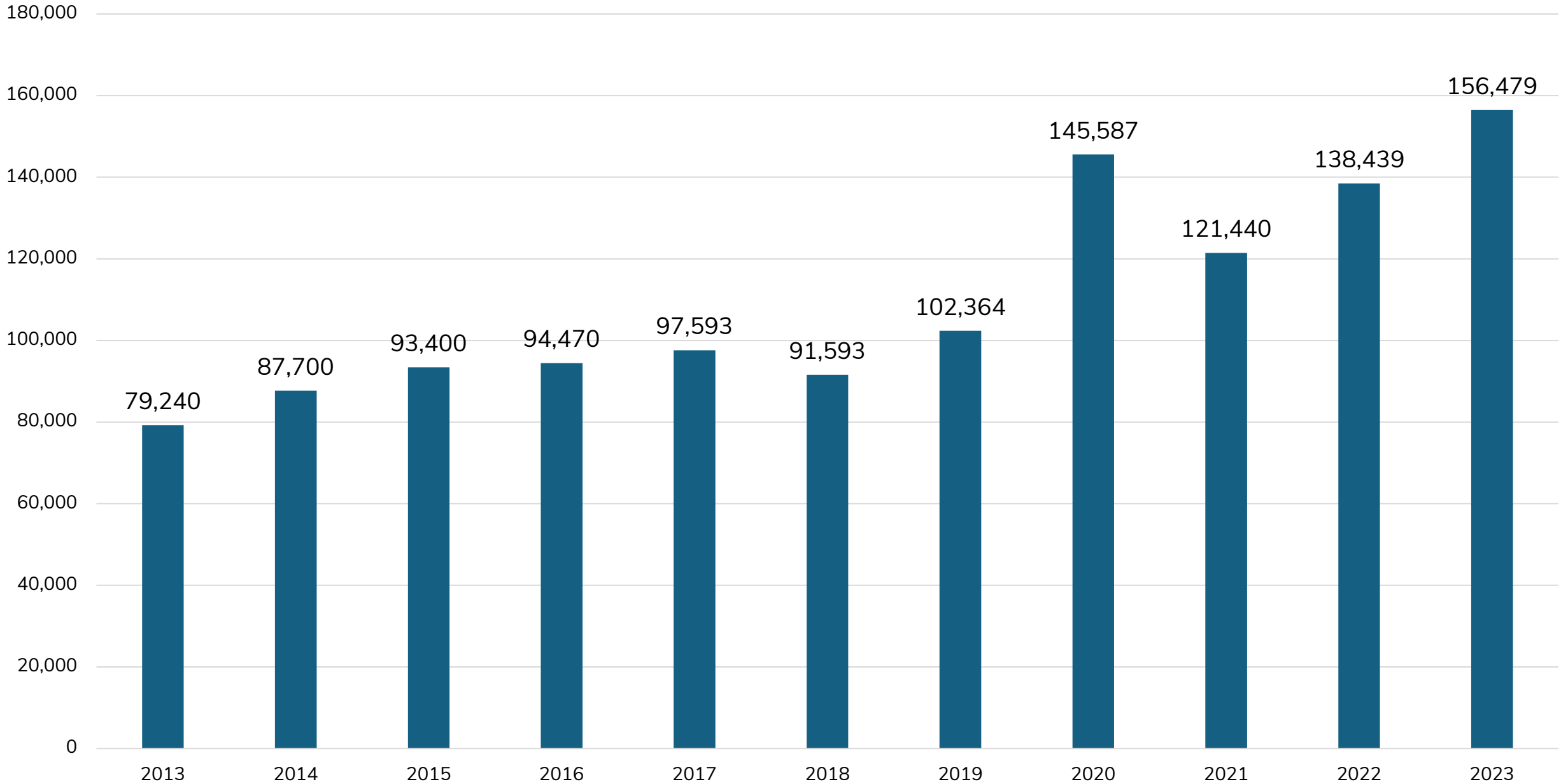

Pounds Distributed

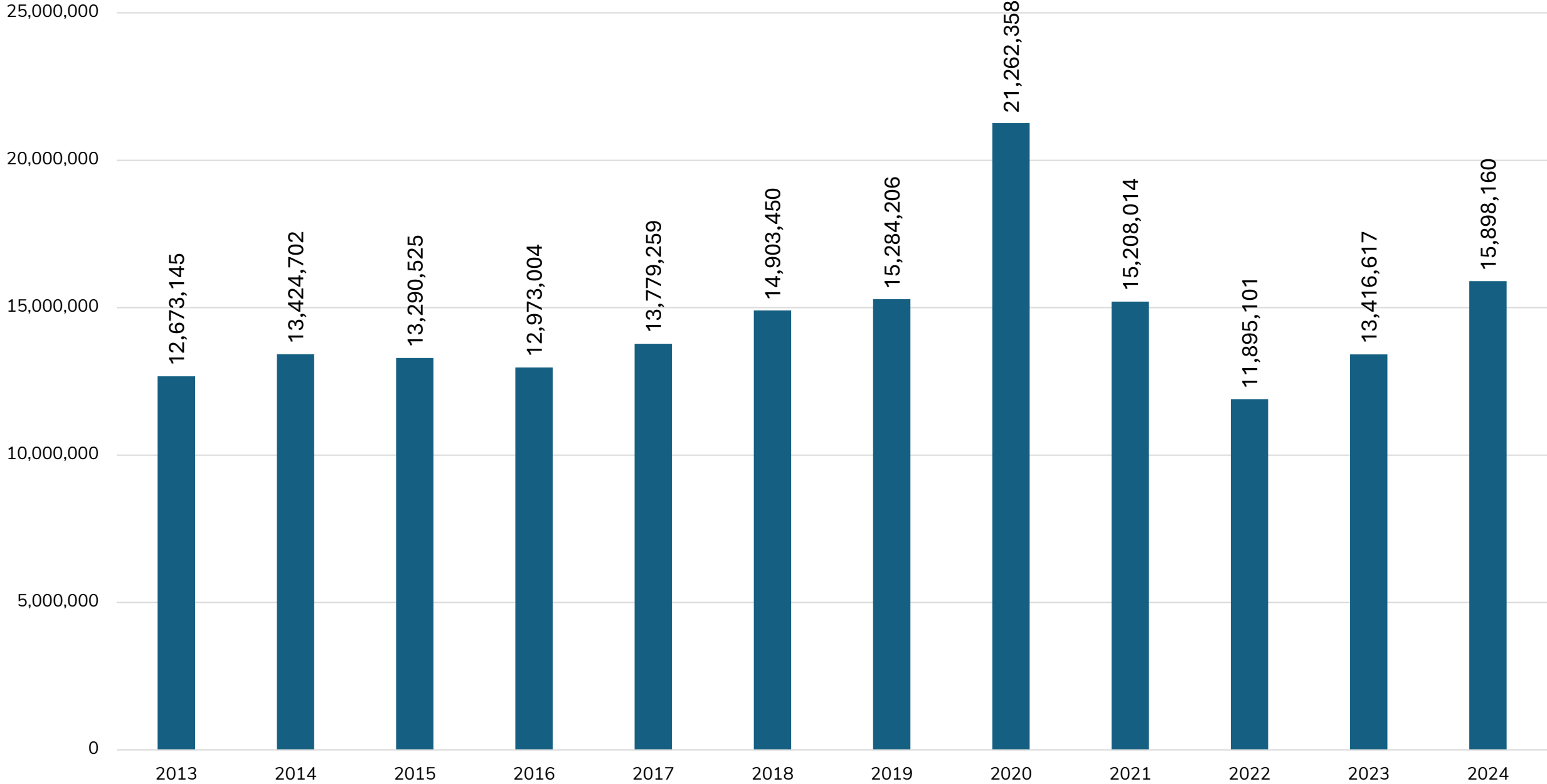



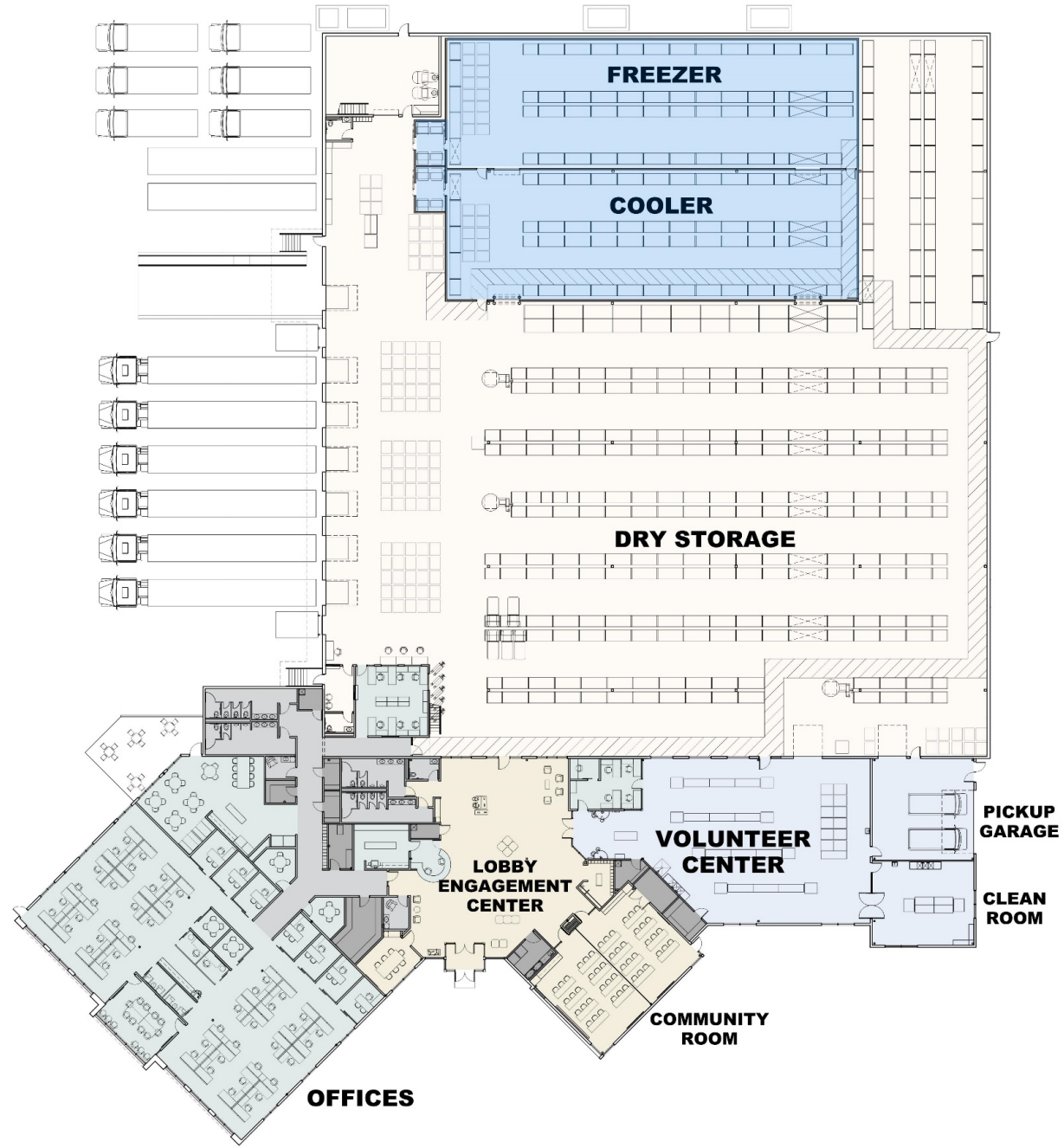

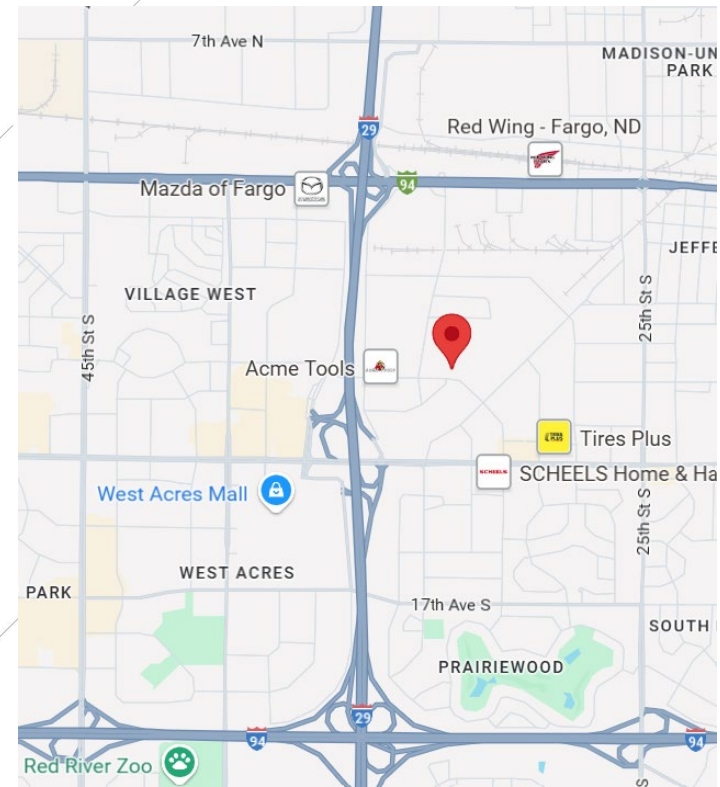
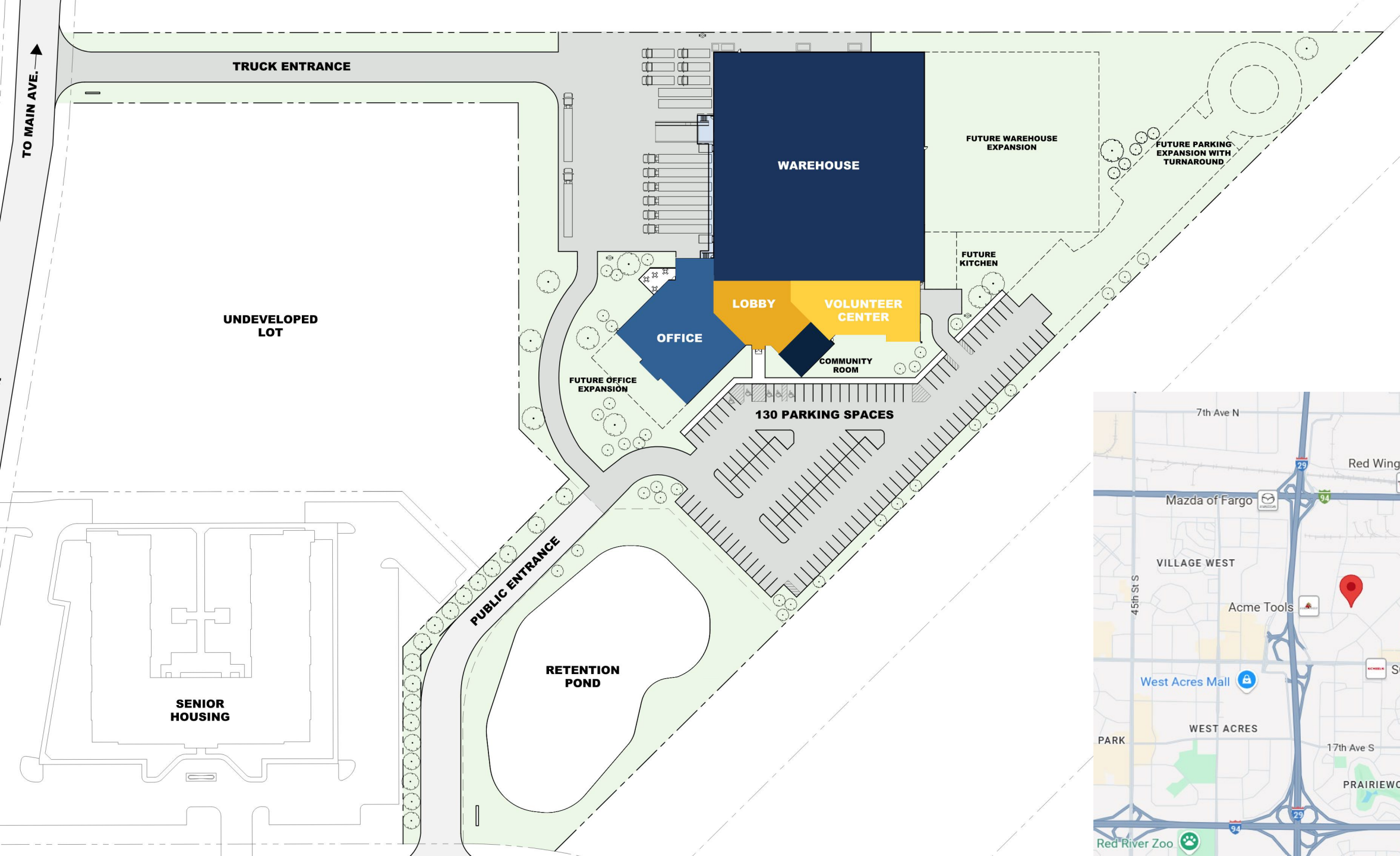

Revenue



Annual Support

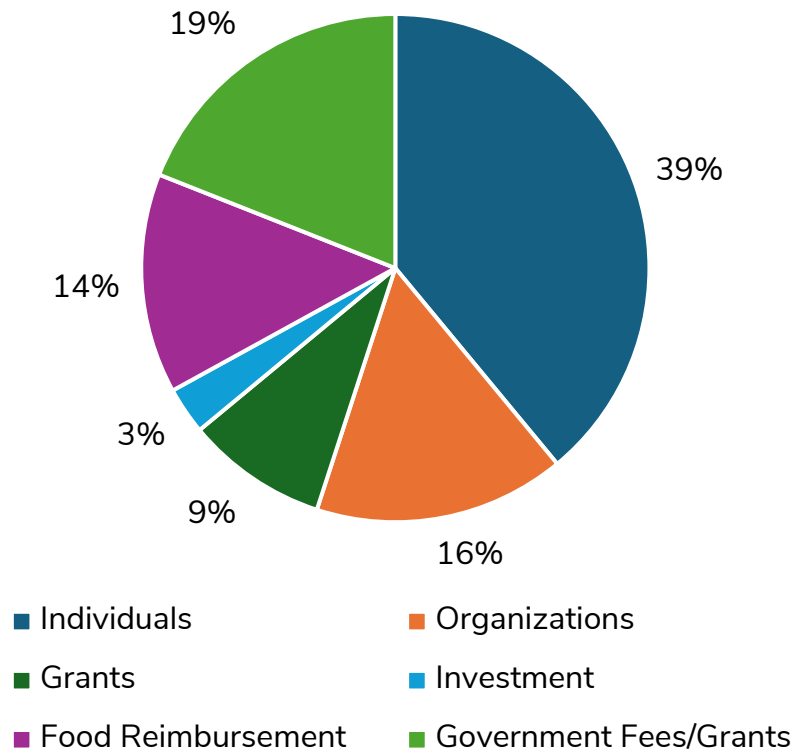

Total Cost New Facility **\$30,500,000**

Revenue	\$10,911,413
Private Contributions	936,413
CDBG-CV Grant	2,000,000
GPFB Reserves	900,000
Building Sale*	2,500,000
New Markets Tax Credits*	4,575,000
Remaining	\$19,588,587



GREAT PLAINS
FOOD BANK