









NORTH DAKOTA STATE CAPITOL

Ground Floor

- Employee Entrance/Emergency Exit 
- Stairs 
- Elevator (Gold/Tower) 
- Elevator 
- Public Restrooms 
- Legislative Areas 
- Legislative Committee Rooms 
- Other/Storage/Agency 

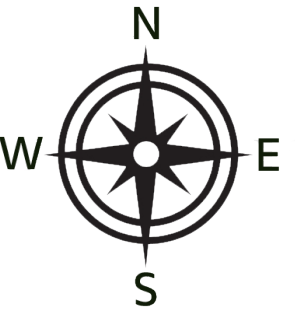

Ft. Totten Room



2nd Floor Tower

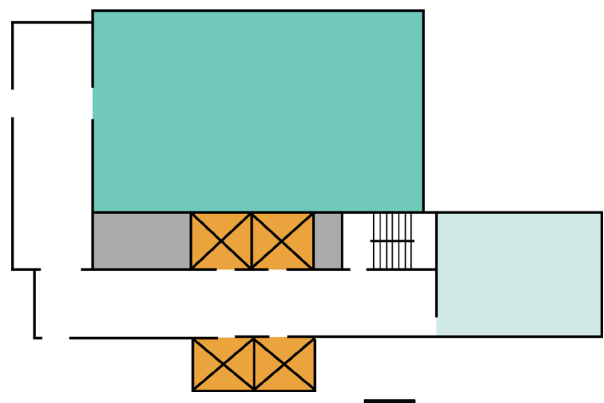

Judicial Wing Ground Floor

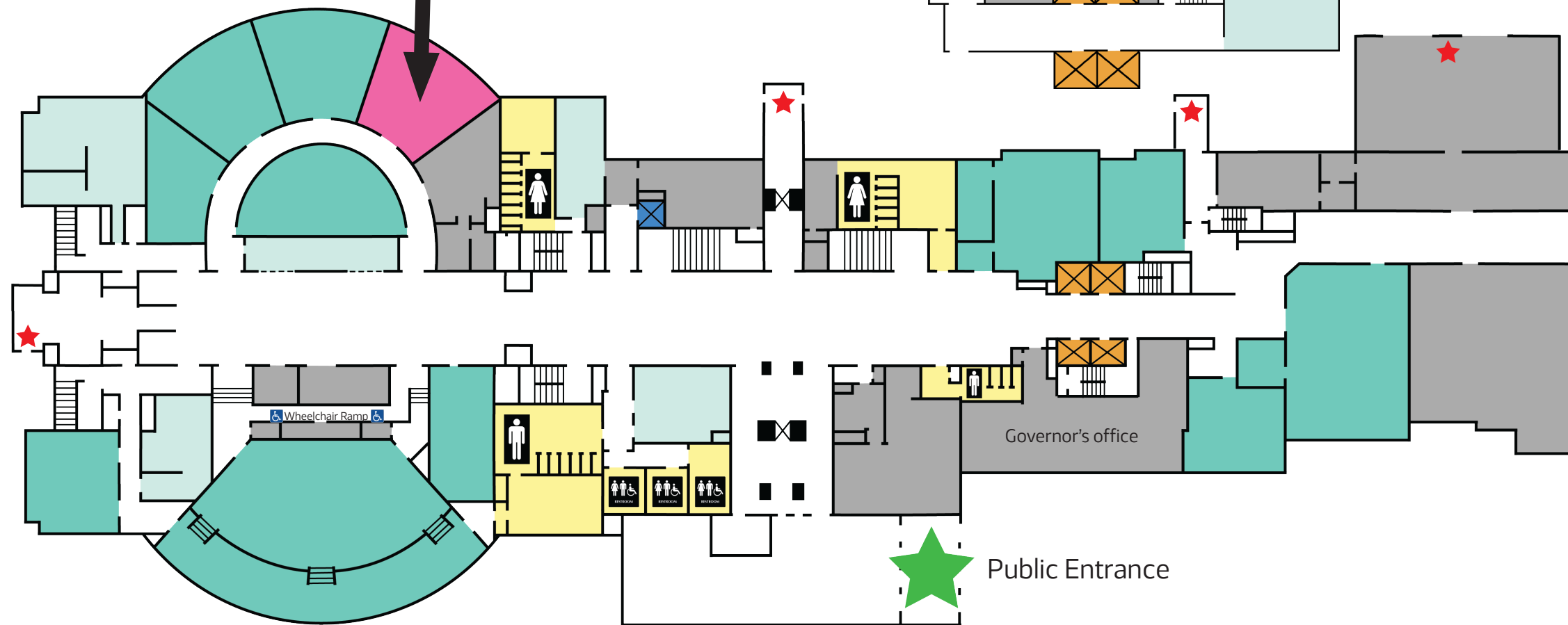
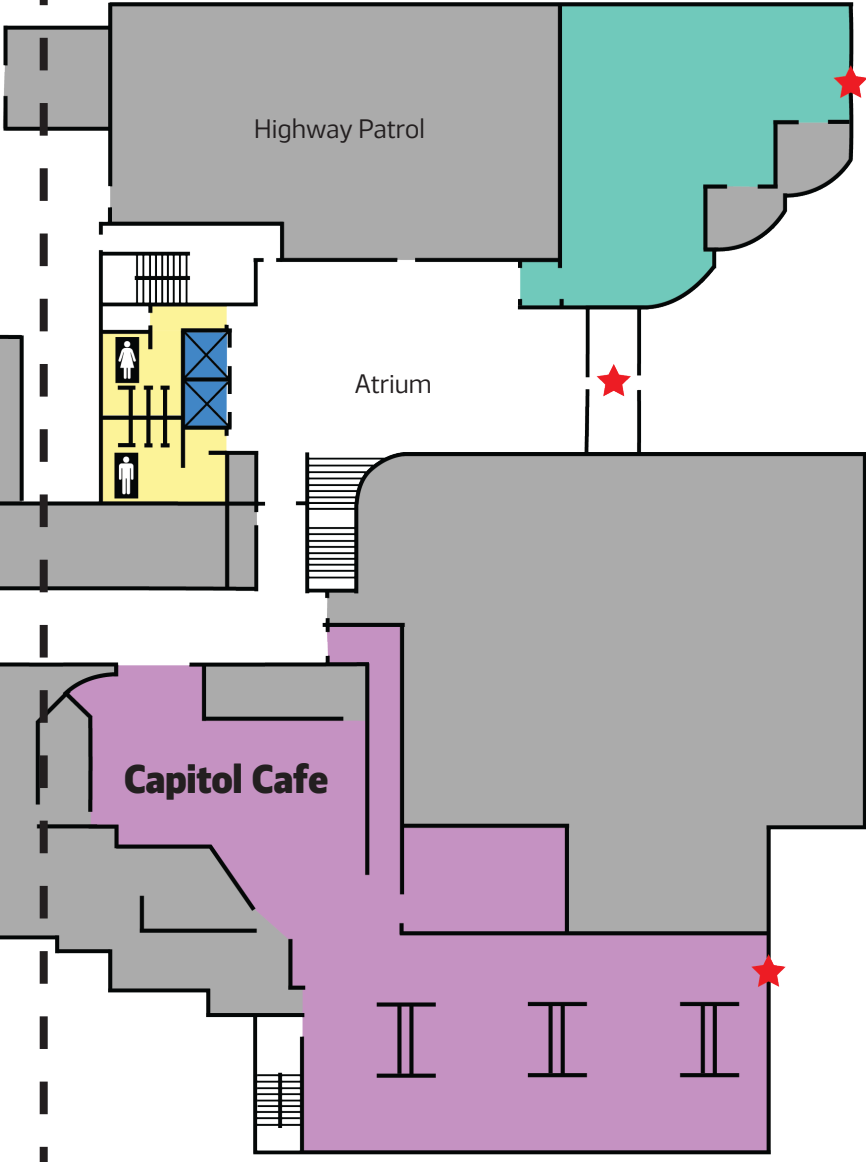

Public Entrance